



User Guide

Danalogic Clip Bodyworn



DANALOGIC CLIP BODYWORN PERSONAL HEARING SYSTEM

This booklet describes the features available for the Bodyworn hearing instrument model in the Danalogic Clip.

Danalogic's advanced technology will offer you the best possible hearing solution to maximize listening situations in your family life, your professional life and your social life.

Your hearing instrument has been adjusted for your individual hearing loss. Please familiarize yourself with the information in this booklet. Proper understanding and use of your new Danalogic hearing instrument will allow you to derive maximum hearing benefit.

This booklet & your instrument

In this booklet you will find instructions for inserting, using and caring for your new hearing instrument.

Contents

page

Your Danalogic Clip Hearing Instrument	4
On/Off Function	5
Low Battery Warning	5
Changing the Battery	6
Battery Warning Information	6
Assembling the Cord & Earphone	7
Inserting & Removing your hearing instrument	8
Using two ear phones	10
Wearing the instrument	10
Pre-Set controls – trimmers	11
User operated controls	11
Volume Control	11
Programme Selector	12
Direct Audio-input facility	14
Telephone use	15
Using loop systems	16
Daily Maintenance	17
Repairs	17
Ear Mould	18
Cleaning the Ear Mould	18
General Precautions	19
Troubleshooting Guide	20
Technical Data	22

Your Danalogic Clip hearing instrument

- | | |
|------------------------|----------------------|
| 1. Microphone | 6. Trimmers |
| 2. Volume Control | 7. Earphone cable |
| 3. Programme selector | 8. Clothing clip |
| 4. Battery Compartment | 9. Battery indicator |
| 5. On/off | |

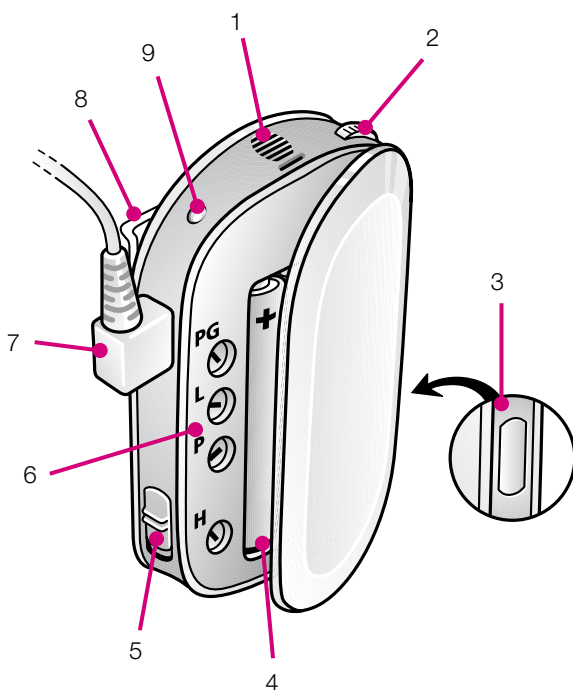

Turning on and off

Your Danalogic Clip Bodyworn is equipped with an on/off switch.

Turn your hearing instrument on by pushing the On/Off switch down, and turn your instrument off again by pushing the On/Off switch up.

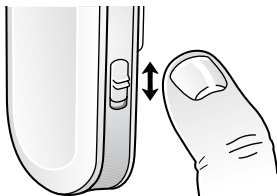

When first turned on, your Danalogic Clip hearing instrument will always start in programme 1. To read more on this subject, turn to page 12-13.

It is recommended that you turn your hearing instrument off and open the battery door when you are not using it. This will increase the battery life as well as increase the life span of the hearing instrument.

Low Battery Warning

The hearing instrument has a soft low-battery-warning signal (beep-beep) that you will hear when the battery voltage/power gets too low. The low-battery-warning signal will be repeated every 5-10 minutes until the battery runs out of power. The instrument will then automatically switch off.

It is recommended that you always carry a spare battery with you and replace the battery as soon as you hear the low battery warning signal.

There is also a battery light indicator which will warn you when the battery voltage/power gets too low.

Changing the Battery

The battery compartment can be opened on the side just below the On/Off switch.

Insert the new battery with the + side facing the + inside the battery compartment. If you are replacing an old battery please remove this with the help of the transparent Battery Remove Band before inserting a new one.

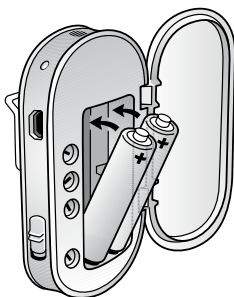

Always use a type 1.5 volt Penlight (IEC 86-R6) battery, and it is recommended to use Alkaline battery for longer battery life time. Please note that a weak battery can cause the hearing instrument power to be reduced.

Battery Warning information

Batteries contain dangerous substances and should be disposed of carefully in the interest of your safety and for the environment.

- Do NOT attempt to recharge batteries which are not specifically designated rechargeable as they may leak or explode.
- Do NOT attempt to dispose of batteries by burning them.
- Keep batteries away from small children and pets.
- Do NOT place batteries in your mouth.

If swallowed, seek immediate medical attention.

Assembling the Cord & Earphone

The hearing instrument will only function when an ear phone receiver is connected to the main body through an ear phone cable and the USB-like plug marked in the illustration below.

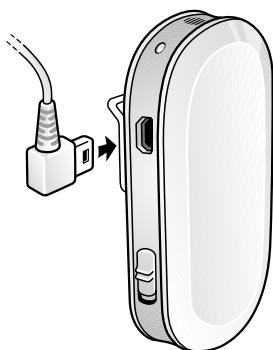

Insert the cable in the receiver outlet indicated and insert the cable in the ear phone. Please make sure that the pins on the cable are fitted to the correct pin holes in the ear phone as they differ in size – see illustration below.

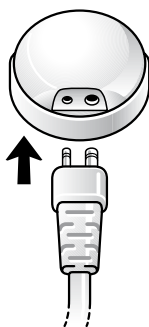

Inserting and removing your hearing instrument

Mounting

Your Danalogic Clip bodyworn hearing instrument may come with a standard ear tip that needs to be attached to the ear phone piece. This ear tip should only be used until you receive a custom ear mould from your hearing care professional.

In the illustration no.1 you will see how the ear tip is fitted to the ear phone and then how that fits into the ear.

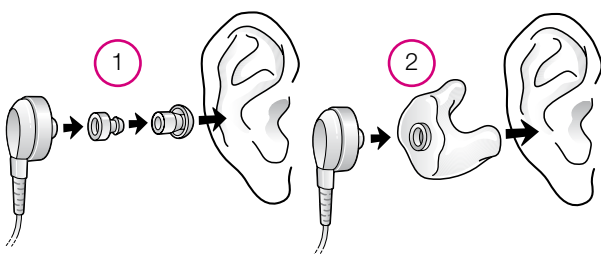

When you receive your custom ear mould, you will need to remove the standard ear tip from the ear phone. The custom ear mould can then be snapped onto the ear phone and you can insert it into your ear as shown in illustration no. 2

Inserting

The standard ear tip is designed to fit most ears. It is important to insert the ear tip properly for a good tight seal; otherwise 'feedback' (whistling) may occur. Insert the ear tip by carefully fitting the tapered end (the portion with the small hole) into your ear canal.

Gently twist the ear tip until it fits comfortably, yet snugly within your outer ear. When inserting the ear tip, it may help to pull down on the ear lobe with your free hand to ensure a secure fit.



To insert the custom canal-type ear mould into your ear, hold the ear mould between your thumb and index finger and position its 'point' in your ear canal.

Now, slide the ear mould all the way into your ear with a gentle, twisting movement. Insertion can be easier if you gently pull your ear back with your other hand.

Turn the top-part of the ear mould gently backwards and forwards so that it fits behind the fold of skin above your ear canal.

Removing

Always turn OFF your hearing instrument before attempting to remove the ear tip or earmould from your ear.

Using two ear phones

The Danalogic Clip hearing instrument can be used with 2 separate earphones. Consult your hearing care professional for proper fit.

Note: The ear phones have been fit for each ear based on your particular hearing loss. It is important to use the correct ear phone for the correct ear. We suggest that you mark your new bodyworn hearing instrument with an L for left ear and an R for right ear together with your hearing care professional.

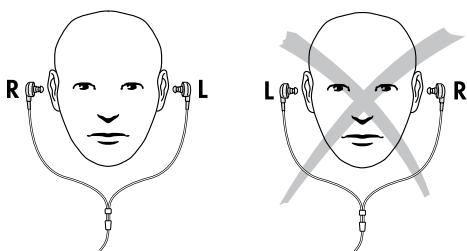

Wearing the instrument

The bodyworn instrument should be worn on the chest with a band, or placed in a pocket or in a bag. Use the attached clip to fasten the hearing instrument in place.

Care should be taken to ensure the top of the hearing instrument is not covered. If the top portion of the instrument, containing the microphone, is covered, it can result in poor sound quality or in reduced volume.

Pre-set controls - Trimmers

Bodyworn hearing instruments have controls that are located inside your instrument and should only be adjusted by your hearing care professional.

They have been set according to the individual characteristics of your particular hearing impairment and should NOT be readjusted without consulting your hearing care professional.

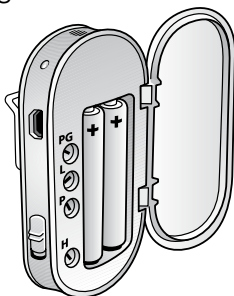

User-operated controls

Volume control

The Danalogic Clip instrument has a volume control which allows you to set and control the volume manually. The volume wheel has numbers on it ranging from 1 to 10, with 10 being the maximum volume setting. During the fitting of the hearing instrument, your hearing care professional will select an optimal volume setting for you.

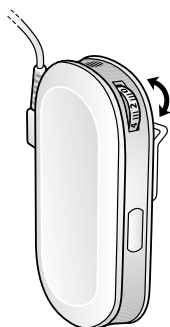

Please note the setting of that particular level. To increase the volume with the instrument fit to your ear, turn the volume control wheel up. To reduce the volume, turn the wheel down.

Please note that your instrument has been fit by your hearing care professional and that your hearing loss requires a certain amount of amplification. This will also affect how much you are able to increase the volume on your instrument.

Programme Selector

Your hearing instrument has a programme selector allowing you to use up to four separate programmes.

- Programme 1 is the default programme. In this programme, you will hear sound that is picked up through the microphone of the hearing instrument.
- Programme 2 is the restaurant/party program. It is specifically designed to make it easier for you to hear in noisy situations.
- Programme 3 is a combination of the Microphone and Telecoil functions. In this programme, you will hear sound that is picked up through the microphone as well as sound that is delivered through the telecoil of the hearing instrument. The telecoil is designed to enable you to hear on telecoil-enabled telephones or in places which have an induction loop system (see pages 15-16 for additional information)
- Programme 4 is the Direct Audio Input programme (see page 14 for additional information).

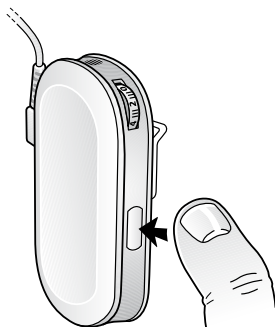

When you push the programme selector you will hear one, two, three or four “beeps”, indicating which programme you have selected. You can access the different programmes by pushing your finger down on the button as shown in the illustration.

- The hearing instrument automatically defaults to programme 1. You will hear 2 beeps when you are in programme 2, 3 beeps when in programme 3 and 4 beeps when in programme 4.
- If you are in programme 2, 3 or 4 and want to get back to programme 1, press the programme button until you hear just 1 beep.

You can also set your instrument to programme 1 by turning it off and then on again.

Direct Audio Input

The Danalogic Clip hearing instrument has the functionality to connect to a Direct Audio Input system.

To use the Direct Audio-Input system, you must disconnect the standard ear phone cable as shown in diagram 1 and connect the special audio-input cable as shown in diagram 2.

A special audio-input cable can then be connected to the hearing instrument as shown in diagram 3. The other end of the audio-input cable (pins on it) must then be connected to the ear phones.

When using the audio-input system set the Programme selector in programme 4.

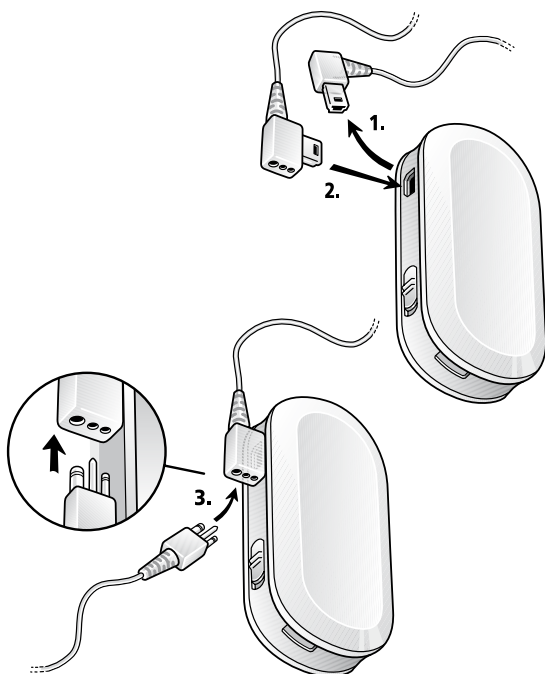

Telephone use

Some experimentation is required when using a telephone with your hearing instrument.

Programme 3 offers telecoil pick up.

This feature can only be used with telecoil (hearing aid) compatible telephones. Place the receiver of the telephone over the hearing instrument, not the ear. (see illustration).

It is recommended that you reposition the receiver of the telephone and the hearing instrument until you get the loudest and clearest signal.



Using loop systems

Many public places, such as churches, theatres and cinemas, have induction loop systems set up in them. Homes can also have radios or televisions that are connected to an induction loop system. When an induction loop is used, sound is transmitted directly to the telecoil of the hearing instrument. The advantage to using a telecoil is that sound quality through an induction loop is often better because noise from the environment is not amplified. To set up your hearing instrument to be used with a loop system:

1. Set the hearing instrument program to the telecoil setting.
 2. Hearing reception might be better in certain parts of the room than others. If you are having difficulty hearing, try moving to a different location, within the room, to see if this improves your hearing reception.
 3. Increase or decrease the volume on your hearing instrument as necessary.
 4. After you are done listening through the induction loop, set the hearing instrument back to program 1, which is the standard program.
- If the sound in the telecoil programme is consistently too soft or too loud, ask your hearing care practitioner to adjust the program accordingly.

Daily maintenance

Keep your hearing instrument clean and dry. Wipe the case with a soft cloth or tissue after use to remove oil or moisture. If the instrument has been exposed to high humidity or perspiration, enclose it (with the ear mould) in a sealed container together with a drying agent (desiccant) overnight. Consult your hearing care professional concerning which drying agent to use.

To prevent unwarranted repairs:

- Never immerse the instrument in water or other liquids since this may cause permanent damage to the circuitry.
- Protect your hearing instrument from rough handling, and avoid dropping it on hard surfaces or floors.
- Do not leave the instrument in or near direct heat or sunlight since excessive heat can damage the instrument or casing.

Repairs

If your Danalogic Clip hearing instrument malfunctions, it must be repaired by a qualified technician. Do not attempt to open the case of the hearing instrument since this would invalidate the warranty.

If your Danalogic Clip hearing instrument requires service, please contact your hearing care professional for assistance.

The ear mould

The standard test ear tip should only be used until you receive your custom ear mould. Full benefit from your hearing instrument can only be obtained when a custom made ear mould is used.

The ear mould feeds the amplified sounds from the hearing instrument into the ear. It is important that the ear mould fits correctly into your ear. If the ear mould irritates your ear in any way and prevents you from wearing your hearing instrument, please contact your hearing care professional to have the ear mould modified. You should never attempt to modify the shape of the ear mould yourself.



Cleaning the ear mould

The ear mould should be cleaned every day. Before cleaning the ear mould, unsnap it from the ear phone receiver. Use lukewarm water to clean wax and moisture off the ear mould.

If ear wax is stuck in the sound canal of the ear mould, a cleaning loop or a syringe with lukewarm water can be used to help “push” the wax out. Make sure not to leave the ear mould wet after cleaning and dry the metal ring to avoid corrosion.

General precautions

Consult a physician if you find a foreign object in your ear canal, if you experience skin irritation or if excessive earwax accumulates with the use of the hearing instrument.

- Different types of radiation, e.g. from NMR, MRI or CT scanners, may damage the hearing instrument. Therefore, do not wear the hearing instrument during these or other corresponding scanning procedures. Other types of radiation (burglar alarms, room surveillance systems, radio equipment, mobile telephones, etc) contain less energy and will not damage the hearing instrument. However, they can momentarily affect the sound quality or cause the hearing instruments to emit strange sounds.
- Warning: Do not wear the hearing instrument in mines or other explosive areas, unless those areas are certified for hearing instrument use.
- Warning: When dealing with children special care should be exercised with the ear phone cables to ensure that they do not get tangled up in them and risk getting suffocated.
- Warning to hearing care practitioners Special care should be exercised in selecting and fitting hearing instrument(s) whose maximum sound pressure level exceeds 132 dB SPL with an IEC 60711: 1981 occluded ear simulator, because there may be a risk of impairing the remaining hearing of the hearing instrument user.

TROUBLESHOOTING GUIDE

SYMPTOM	CAUSE
No sound	<ul style="list-style-type: none">• Not turned on• Dead Battery• Battery improperly inserted• Blocked ear mould or tube
Not loud enough	<ul style="list-style-type: none">• Battery low• Loose ear mould• Blocked ear mould or dome• Change in hearing• Excessive ear wax• Volume set too low
Whistles	<ul style="list-style-type: none">• Loose ear mould• Ear mould too small
Sound not clear or distorted	<ul style="list-style-type: none">• Weak battery• Poorly fitting ear mould or dome• Hearing instrument damaged• Hearing instrument settings not optimal

If there are any other problems not mentioned in this guide, please contact your hearing care professional.

POSSIBLE REMEDY

- Turn on
- Replace battery
- Insert battery properly
- Clean ear mould or tube blockage

- Replace battery
- Reinsert carefully
- Clean ear mould or dome
- Consult your hearing care professional
- Consult your physician
- Consult your hearing care professional

- Remove and reinsert
- New ear mould required

- Replace battery
- Consult your hearing care professional
- Consult your hearing care professional
- Consult your hearing care professional



Technical Data

Maximum Output (2cc Coupler / IEC 60118-7)

Danalogic Clip	145 dB SPL (Typical)
----------------	----------------------



Please ask your local hearing care professional concerning disposal of your hearing instrument

Worldwide Headquarters

GN ReSound A/S
Lautrupbjerg 7
DK-2750 Ballerup, Denmark
Tel.: +45 45 75 11 11
Fax: +45 45 75 11 19
www.resound.com

United Kingdom

GN ReSound Ltd.
1 Landscape Close
Weston Business Park
Weston-on-the-Green
Oxon OX25 3SX
Tel.: 0 1869 352 800
Fax: 0 1869 343 466
www.danalogic-ifit.com



Any issues relating to the EU Medical Device
Directive 93/42/EEC should be directed to
GN ReSound A/S